

## Sopal 2408-LA00

Type: Suspension/Pendant

Matériaux/Materials: Aluminium powder coat •  
Verre/Glass

Specifications: E26 base LED, 120 volts, dimmable

Ampoule/Bulb: Tala Sphere I 6 Watt • 480 Lumens •  
2000K to 2800K Dim to warm

Poids/Weight: 3.6 lb.

Garantie/Warranty: 2 ans/years

Certification: 

Usage intérieur seulement/Indoor use only

Lien 3D/link: [Cliquez ici/Click here](#)



Pour tous les fichiers 3D, incluant CAD, Revit et IES,  
visitez le [www.luminaireauthentik.com](http://www.luminaireauthentik.com) / For 3D drawings of all products,  
including CAD, Revit and IES files, please visit [www.luminaireauthentik.com](http://www.luminaireauthentik.com)

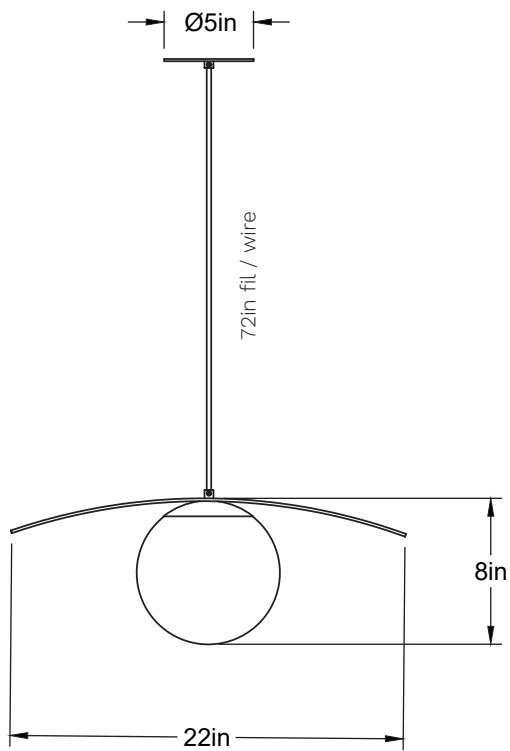

Avant/Front

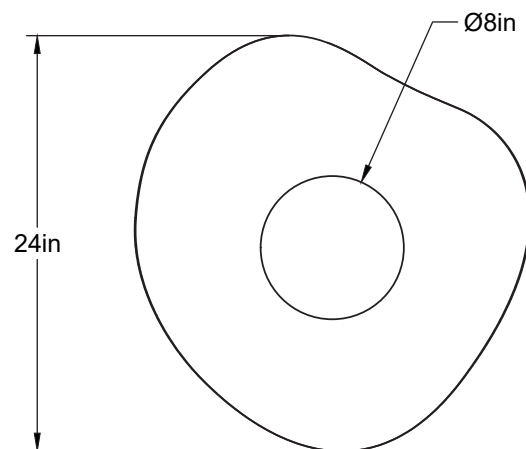

Dessus/Top

## Abat-jour/Shade Ext.



## Couleur boule de verre/Glass ball colour

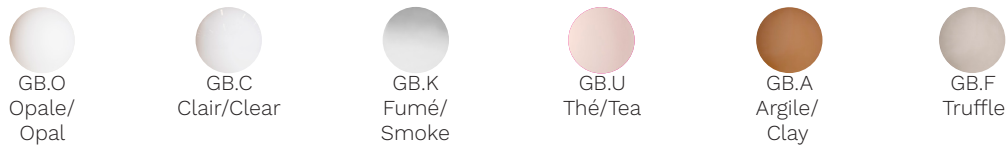

## Finition boule de verre/Glass ball finish



## Fil/Wire



TBK



TWT



TCH



TWG



TCR



TND



TCP



TCT



TOR



TCF



TTF



TSE

## Quincaillerie/Hardware



BRR



NIR



Même A-J/  
Same as shade



Même tige/  
Same as rod

## Canopy style + colour



BRR (\$)



WTM



Même A-J/  
Same as shade



Même fil/  
Same as wire



03

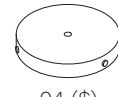

04 (\$)

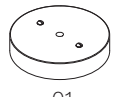

01